

Switchable Privacy SGULLC.0110 Specifications

UL LISTING CATEGORY: IYQX.E216500

Function:

Provides instant switchable privacy for a translucent, milky white, laminated panel to become transparent with the application of an electrical current to an embedded layer of liquid crystal particles.

Switching Action:

An array of switching options are available from a basic single-pole/single throw switch to advanced integration into home automation systems.

Dimension:

Maximum width: 54" (1371mm)
Maximum length: 120" (3048mm)
Larger custom sizes available.

Energy Data:

Input Power:	Energy Consumption:
120VAC /60Hz	~3 watts/ sq meter
	0 Watts in privacy state

Thickness (Glass):

Maximum Thickness: (unlimited)
Minimum Thickness: 5/16" (7.9mm)
[average thickness @ 7/16"]

Thickness (Polycarbonate):

Maximum Thickness: (unlimited)
Minimum Thickness: 1/16" (1.58mm)

Performance Data:

Parallel Light Transmission:
On: 70% / Total Light: 80%; Haze Range: 5-10%, dependent on type and thickness of substrates used
Off: 5% / Total Light: 75%; Haze Range: Full, dependent on type and thickness of substrates used

Switching Speed:

Private to Transparent: Approx 7 ms
Transparent to Private: Approx 17 ms

Operating Temp:

0-70°C

Method of Action:

Electrical current either aligns or randomizes liquid crystals to achieve desired transparency. (Default is Private)

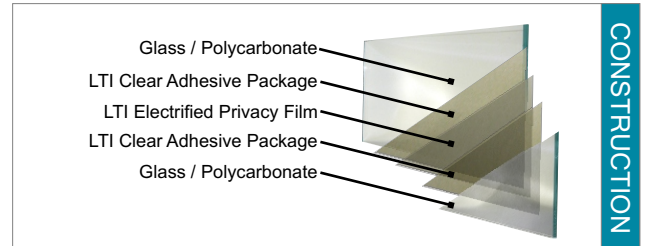

This product is manufactured using ANSI Z97.1 for laminated safety glass construction

Installation Data:

Wet Glazing Sealant Specification:

See LTI LC installation manual for additional glazing details and cautions

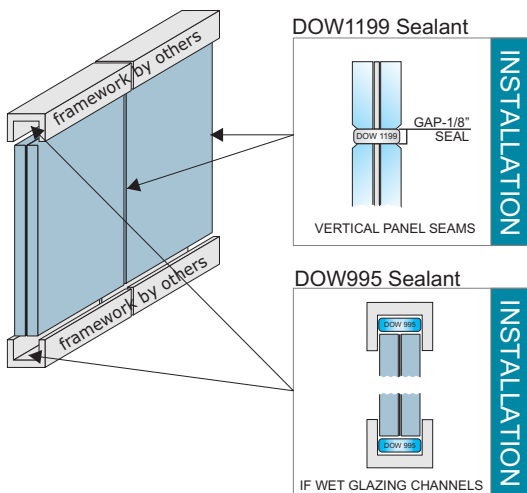

Power Leads:

Leads generally exit top center of panel - 10' of lead standard

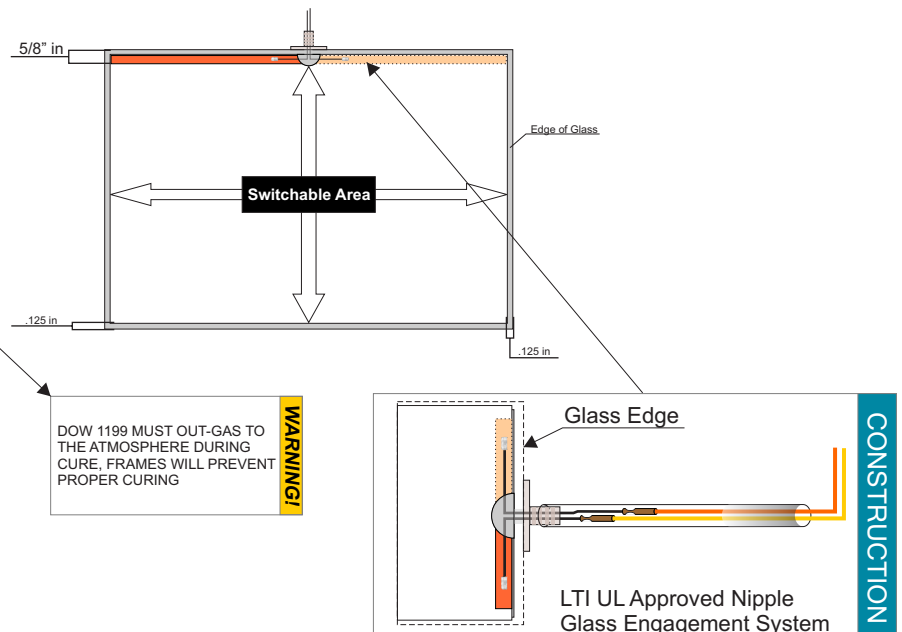

WARNING!
DOW 1199 MUST OUT-GAS TO THE ATMOSPHERE DURING CURE. FRAMES WILL PREVENT PROPER CURING

CONSTRUCTION